



QUIET, WARMTH & STYLE



Product Guarantee

Here at Granada we aim to supply a product that – with regular maintenance – will give many years of trouble-free operation.

We have invested heavily into our machinery, premises and people, to ensure that the quality of the finished product is consistently delivered to the best of our ability.

Through these commitments to quality, we are confident in surpassing other window manufacturers with the comprehensive warranty that we offer on our products and installation.

The warranty period begins from the date of supply, and guarantees that the goods supplied will be free from inherent defects for a period of:

Five years for Aluminium frames and glazing

Two years for moving parts (including, but not limited to springs, locks, handles, rollers, hinges etc.)

Horizontal Sliding

SS2 or HSS2

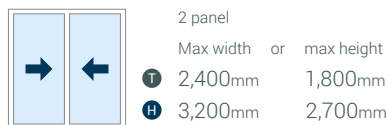

CO3 or HCO3

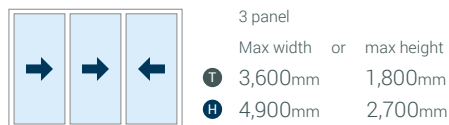

SS3 or HSS3

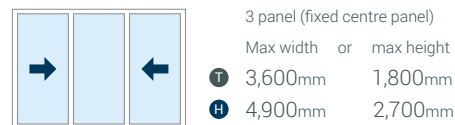

SS4 or HSS4



SS5 or HSS5

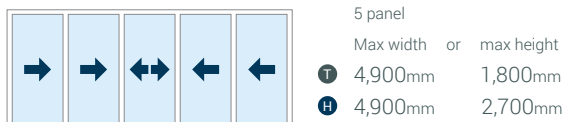

Vertical Sliding

BVS or HBVS



TBVS or HTBVS



Insert Panel

INS

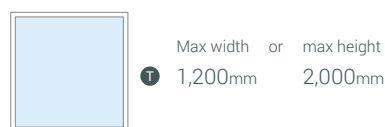

Lift Out

LO or HLO

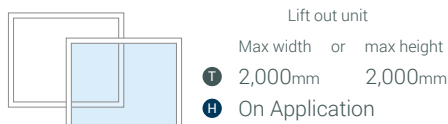

SLLO

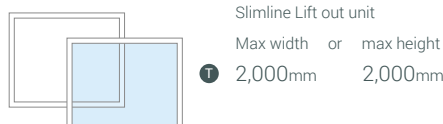

Hinged Casement

HU

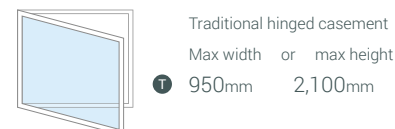

Optional extras:

- Curved head window
- Gothic head window
- Trickle vent
- Acoustic trickle vent
- Acoustic tile board
- Shaped corners
- Flyscreen

Hinged Casement - (Heritage hinged unit will house up to 28mm sealed unit)

HHU or HHU-TT

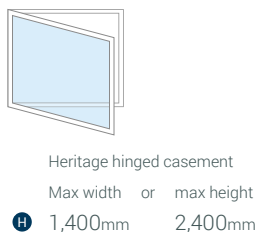

DHHU

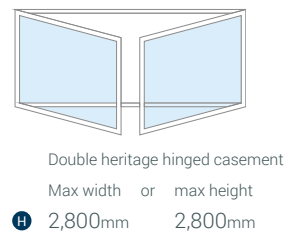

All windows are supplied fully assembled and ready to install. Units comprise of an aluminium outer frame joined to a seasoned hardwood timber surround.

Lift Out (LO)

A removable panel within its own outer frame, fixed to the face or reveal of the existing window. These units use an aluminium twin track profile, to provide a secure fixing for larger panes of glass.

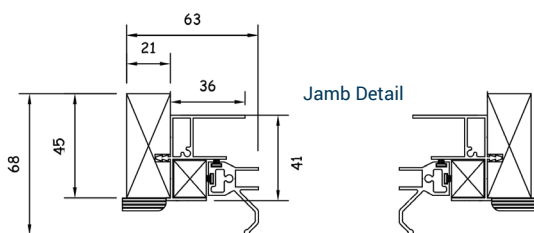

Jamb Detail

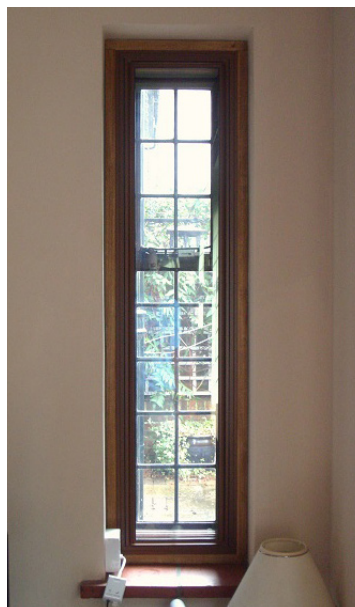

Head Detail

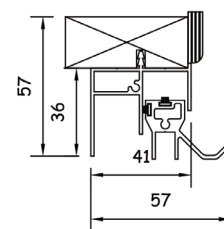

Cill Detail

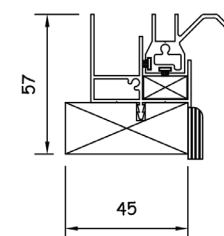

Features

- Slim, unobtrusive aluminium profile
- Economical option to secondary glaze primary window
- Improved noise and thermal installation
- Suitable for arched and shaped applications
- Suitable to have bevelled timber subframe to fix in to bays / splayed reveals
- Can be coupled or stacked with other units in the range to treat large areas of glazing or long runs of windows
- Easy to remove panel for cleaning and maintenance of primary window

Variations of Basic Unit

- Anti lift bolt is available to secure panel in place (fitted through subframe)
- No Subframe version available
- Slimline option available
- Standard and acoustic trickle vents are available duty frame coupling section or timber to timber
- Larger trims and timber trims available at additional costs
- Variety of stock colours available, including all RAL options
- Can accept flyscreen mesh
- Curved in plan option available

Specification

- Glazing options: 4mm - 6.8mm
- Choice of timber subframes
- Pre-drilled and countersunk to suit either face fix or reveal fix
- Woolpile inserted in to panel section groove to create outer frame seal
- Gasket colour option of black or white
- PVCu trims supplied for the face of the units to create a neat, clean finish
- Standard colour white high gloss - RAL 9910
- Lift out section has one rib running along the section

Traditional
Configurations

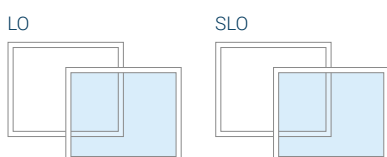

Based on 4mm Glass

Max width: 2,000mm
or Max height: 2,000mm



Optimum Noise Reduction: 52dB (Rw)

Using 6.4mm acoustic laminate glazing, with 200mm glass-to-glass



Optimum U Value: 1.868 W/m²K

Using 4mm toughened Low E glazing, with 80mm glass-to-glass

Slimline Lift Out (SLLO)

A removable secondary glazing panel within its own outer frame, which fixes to the face or reveal of the existing primary window. An ideal solution when only occasional cleaning access is required.

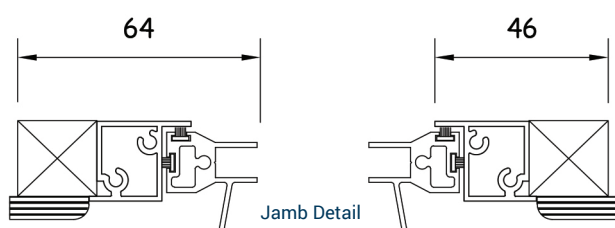
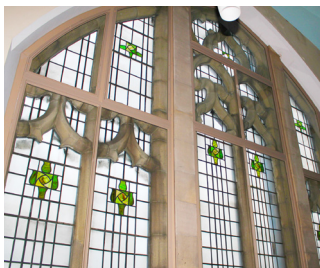

Head Detail

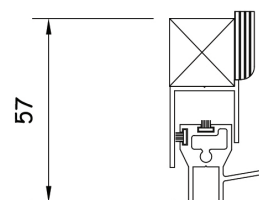

Cill Detail

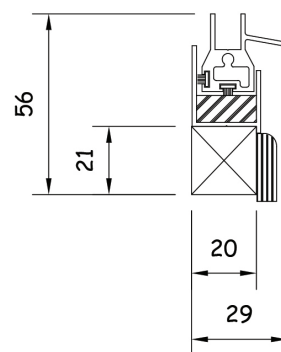

Features

- Slim, unobtrusive aluminium profile
- Economical option to secondary glaze primary window
- Improved noise and thermal installation
- Suitable for arched and shaped applications
- Suitable to have bevelled timber subframe to fix in to bays / splayed reveals
- Can be coupled or stacked with other units in the range to treat large areas of glazing or long runs of windows
- Easy to remove panel for cleaning and maintenance of primary window

Variations of Basic Unit

- Standard and acoustic trickle vents are available
- Larger trims and timber trims available at additional costs
- Variety of stock colours available, including all RAL options
- Can accept flyscreen mesh

Specification

- Glazing options: 4mm - 6.8mm
- Choice of timber subframes
- Pre-drilled and countersunk to suit either face fix or reveal fix
- Woolpile inserted in to panel section groove to create outer frame seal
- Gasket colour option of black or white
- PVCu trims supplied for the face of the units to create a neat, clean finish
- Standard colour white high gloss - RAL 9910
- Lift out section has one rib running along the section

Traditional
Configurations

SLLO

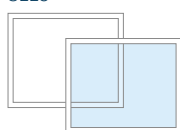

Based on 4mm Glass

Max width: 2,000mm
or Max height: 2,000mm



Optimum Noise Reduction: 52dB (Rw)

Using 6.4mm acoustic laminate glazing, with 200mm glass-to-glass



Optimum U Value: 1.868 W/m²K

Using 4mm toughened Low E glazing, with 80mm glass-to-glass

Lift Out (HLO)

A removable secondary glazing panel within its own outer frame, which fixes to the face or reveal of the existing primary window. An ideal solution when only occasional cleaning access is required.

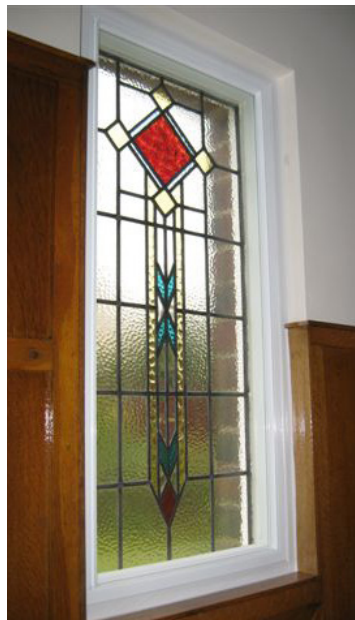

Head Detail

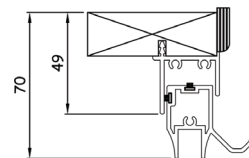

Cill Detail

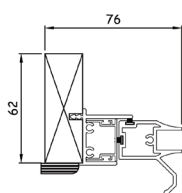
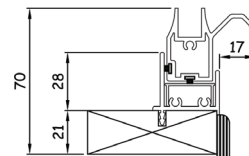

Jamb Detail

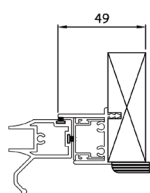

Features

- Slim, unobtrusive aluminium profile
- Economical option to secondary glaze primary window
- Improved noise and thermal installation
- Suitable for arched and shaped applications
- Suitable to have bevelled timber subframe to fix in to bays/splayed reveals
- Can be coupled or stacked with other units in the range to treat large areas of glazing or long runs of windows
- Easy to remove panel for cleaning and maintenance of primary window

Variations of Basic Unit

- Anti lift bolt is available to secure panel in place (fitted through subframe)
- No subframe version available
- Standard and acoustic trickle vents are available
- Can be coupled and stacked using a heavy duty frame coupling section or timber to timber
- Larger trims and timber trims available at additional cost
- Variety of stock colours available, including all RAL options
- Can accept flyscreen mesh

Specification

- Glazing options: 4mm - 8.8mm
- Choice of timber subframes
- Pre-drilled and countersunk to suit either face fix or reveal fix
- Woolpile inserted in to panel section groove to create outer frame seal
- Gasket colour option of black or white
- PVCu trims supplied for the face of the units to create a neat, clean finish
- Standard colour white high gloss - RAL 9910
- Lift out section has one rib running along the section

Heritage
Configurations

HLO



Based on 4mm Glass

Max width: 2,000mm
or Max height: 2,000mm



Optimum Noise Reduction: 52dB (Rw)

Using 6.4mm acoustic laminate glazing, with 200mm glass-to-glass



Optimum U Value: 1.868 W/m²K

Using 4mm toughened Low E glazing, with 80mm glass-to-glass

Minimum & Maximum Size Guide

On Application

Windows in this area are beyond our maximum size limit. However, we may be able to make the windows but we will not offer any guarantee of performance and will accept your order solely on this basis. Alternatively, please redesign the window to comply with the recommended sizes to benefit from the full product warranty.

- Maximum Glass Size 2050 x 3250
- Maximum Window size for delivery: 1800mm x 4000mm - Over sized windows will be packaged as kit form
- MAXIMUM AREA FOR 4mm Annealed / Float GLASS IS 1.6m² - Allow for 4mm TOUGHENED GLASS IF PANEL SIZE EXCEEDS THIS
- MAXIMUM AREA FOR 4mm Toughened GLASS IS 2.5m²
- MAXIMUM AREA FOR 6mm Annealed / Float GLASS IS 3.0m² - Allow for 6mm TOUGHENED GLASS IF PANEL SIZE EXCEEDS THIS
- Flyscreen Maximum size 1200mm in one direction (comes on a roll 1200 wide!)
- HORIZONTAL SLIDERS OVER 1800mm HIGH WILL HAVE 21243 MEDIUM STRENGTHENING INTERLOCK ADDED AT NO EXTRA COST
- HORIZONTAL SLIDERS OVER 2000mm HIGH WILL BE HERITAGE
- Our Standard White = Interpon SA 098E high gloss. Nearest RAL = 9910 high gloss
- Stacked units Standard or Heritage Reveal Fix - If the bottom unit is a Horizontal Slider Support Bars must be used which means deeper timbers. Standard 62mm becomes 70mm. Heritage 70mm becomes 80mm.
- + / - frame tolerance = 3mm
- To estimate the weight of a panel or window use the glass weight for the overall panel or window size.

Multiply width x height x glass weight
4mm glass = 10kg/m² 6mm glass = 15kg/m² 6.4mm glass = 16kg/m²
8mm glass = 20kg/m² 8.4mm glass = 21kg/m²
For double glazed units add the two panes together
- Points to note for any Large Frame
 - Can you get it in the building, up the stairs etc.?
 - Can it be operated safely i.e. Is there room to open a large Hinged Unit?
 - Should it be fixed and only operable by maintenance?
- Insert on plastic hinges must not exceed 10kg
- Minimum Width for Arched Head windows
Insert 400mm (200mm radius)
Lift Out 400mm (200mm radius)
BVS 500mm (250mm radius)
TBVS 500mm (250mm radius)
HTBVS 800mm (400mm radius)
HHU 800mm (400mm radius)
- Horizontal Sliders Panel - Maximum Aspect Ratio Width to Height 1:5
- Vertical Sliders Panel - Maximum Aspect Ratio Width to Height 5:1
- Heritage Hinged Casement Panel - Maximum Aspect Ratio Width to Height 1.5:1

| Secondary Glazing | | Max Panel Weight KG'S | Minimum overall size (equal split) (mm) | | Minimum panel size (mm) | | Maximum size (mm) | | Maximum size (mm) | | On Application (mm) | | Maximum Glass Thickness |
|-------------------|-------------|-----------------------|---|--------|---------------------------|--------|-------------------|--------|-----------------------------|----------------|-----------------------------|----------------|-------------------------|
| | | | | | | | 4mm Glass | | 6mm Glass or 6.4mm Laminate | | 6mm Glass or 6.4mm Laminate | | |
| | | | Width | Height | Width | Height | Width | Height | Width | Height | Width | Height | |
| Standard | SS2 | 40kg | 400 | 250 | 1/2 of min overall width | | 2400 | 1800 | 2400 | 2000 | 4900 | 2000 | 6.8mm |
| | SS3 / CO3 | 40kg | 550 | 250 | 1/3 of min overall width | | 3600 | 1800 | 3600 | 2000 | 4900 | 2000 | 6.8mm |
| | SS4 | 40kg | 700 | 250 | 1/4 of min overall width | | 4900 | 1800 | 4900 | 2000 | 4900 | 2000 | 6.8mm |
| | SS5 | 40kg | 850 | 250 | 1/5 of min overall width | | 4900 | 1800 | 4900 | 2000 | 4900 | 2000 | 6.8mm |
| | INS | 40kg | 200 | 200 | NA | | 1200 | 2000 | 2000 | 2000 | 2000 | 2500 | 6.8mm |
| | BVS | 25kg | 300 | 600 | 1/2 of min overall height | | 1500 | 3000 | 1500 | 3000 | 1600 | 3600 | 6.8mm |
| | TBVS | 25kg | 300 | 700 | 1/2 of min overall height | | 1500 | 3000 | 1400 | 2700 | 1400 | 3000 | 6.8mm |
| | LO | on application | 250 | 300 | NA | | 2000 | 2000 | on application | on application | on application | on application | 6.8mm |
| | SLLO | on application | 250 | 300 | NA | | 2000 | 2000 | on application | on application | on application | on application | 6.8mm |
| | HU | 35kg | 347 | 385 | NA | | 950 | 2,100 | 950 | 2100 | 950 | 2,100 | 6.8mm |
| Heritage | HSS2 | 60kg | 1000 | 500 | 1/2 of min overall width | | 3200 | 2700 | 4900 | 2700 | NA | NA | 8.8mm |
| | HSS3 / HCO3 | 60kg | 1500 | 500 | 1/3 of min overall width | | 4900 | 2700 | 4900 | 2700 | NA | NA | 8.8mm |
| | HSS4 | 60kg | 2000 | 500 | 1/4 of min overall width | | 4900 | 2700 | 4900 | 2700 | NA | NA | 8.8mm |
| | HSS5 | 60kg | 2500 | 500 | 1/5 of min overall width | | 4900 | 2700 | 4900 | 2700 | NA | NA | 8.8mm |
| | HBVS | 48kg | 400 | 900 | 1/2 of min overall height | | 1500 | 3000 | 1400 | 3000 | 1800 | 3800 | 8.8mm |
| | HTBVS | 48kg | 400 | 900 | 1/2 of min overall height | | 1500 | 3000 | 1400 | 3000 | 1800 | 3800 | 8.8mm |
| | HHU | 130kg | 350 | 500 | NA | | 1400 | 2400 | 1500 | 3000 | 1600 | 3200 | 28mm |
| | HHU-TT | 130kg | 600 | 500 | NA | | 1400 | 2400 | 1400 | 2400 | 1400 | 2400 | 28mm |
| | DHHU | 130kg | 700 | 500 | 1/2 of min overall width | | 2800 | 2800 | 3000 | 3000 | 3200 | 3200 | 28mm |
| | HSLO | on application | 500 | 500 | NA | | 2000 | 2000 | on application | on application | on application | on application | 8.8mm |

Important Note! Maximum sizes are for width OR height, not combined i.e. Do not exceed the maximum panel weight.

A LOW-RISK LIFT for a person of average strength and build is considered to be a maximum of 25kg. If you are in any doubt, look to reduce the risk by asking someone to share the lift with you or your client, particularly if you or the client are in a higher risk group e.g. Elderly, Disabled, Pregnant or Young. Refer to <http://www.hse.gov.uk/msd/mad/index.htm> for further help.

Acoustic Performance Results

| Secondary Glazing | Primary Window 4mm Float Glass | | | | Primary Window 6mm Float Glass | | | | Primary Window 4mm Float Glass | | | | Primary Window 6mm Float Glass | | | |
|--------------------------|--------------------------------|-----|-----|-------|--------------------------------|-----|-----|-------|--------------------------------|-----|-----|-------|--------------------------------|-----|-----|-------|
| | 200mm Glass to Glass | | | | 200mm Glass to Glass | | | | 150mm Glass to Glass | | | | 150mm Glass to Glass | | | |
| | SS2 | HHU | BVS | HTBVS | SS2 | HHU | BVS | HTBVS | SS2 | HHU | BVS | HTBVS | SS2 | HHU | BVS | HTBVS |
| 4mm Toughened | 49 | 50 | 49 | 47 | 51* | 51 | 51 | 48 | 48* | 48* | 47* | 46* | 51* | 50* | 50* | 47* |
| 6mm Toughened | 50* | 51* | 51* | 47* | 51* | 52* | 52* | 48* | 49* | 49* | 48* | 46* | 51* | 50* | 50* | 47* |
| 6.4mm Acoustic Laminate | 51 | 52 | 53 | 48 | 52* | 53* | 54* | 50 | 50* | 50* | 49* | 47* | 52 | 51* | 52* | 48* |
| 8.8mm Acoustic Laminate | NA | 52* | NA | 48* | NA | 53* | NA | 49 | NA | 50* | NA | 47* | NA | 51* | NA | 48* |
| 10.8mm Acoustic Laminate | NA | 53* | NA | NA | NA | 54 | NA | NA | NA | 51* | NA | NA | NA | 52* | NA | NA |
| 4/12/6.4mm Sealed Unit | NA | 53* | NA | NA | NA | 53 | NA | NA | NA | 51* | NA | NA | NA | 52* | NA | NA |

Key :

SS2

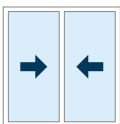

BVS

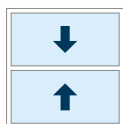

TBVS

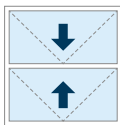

HHU

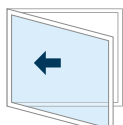

Granada Secondary Glazed windows have been tested at Chiltern Dynamics in accordance with BS EN ISO 10140-2: 'Laboratory measurement of airborne sound insulation of building elements'. The table shows results for secondary windows set at a 200mm and 150mm cavity with 4mm or 6mm float glass in the primary window. Chiltern's Dynamics lab is UKAS Accredited No.1762

* Sound reduction figures predicted by Chiltern Dynamics using the basis of actual laboratory test results. Sound Reduction (Rw) measured in dB.

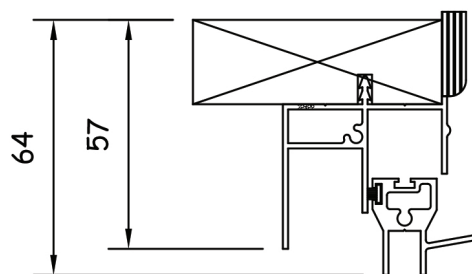
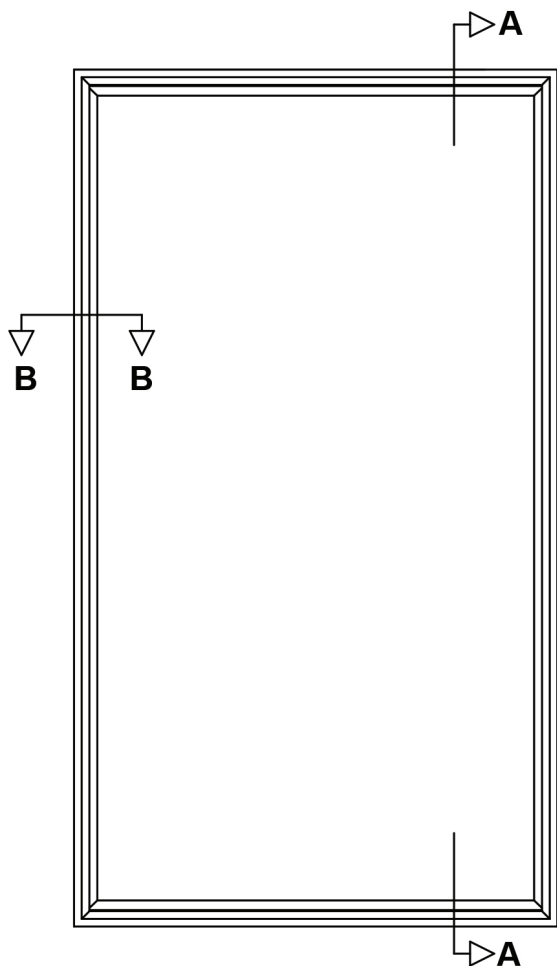

Section A-A

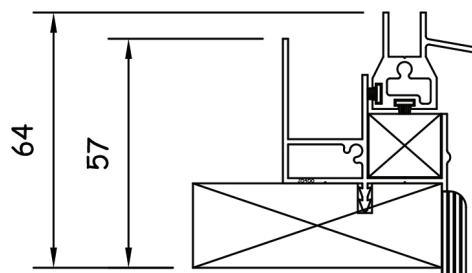

Section B-B

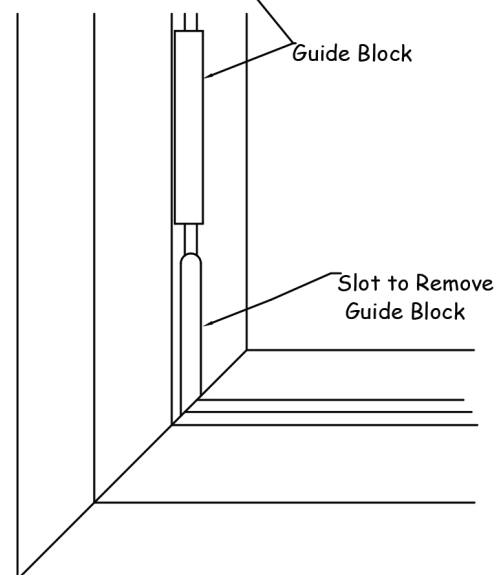
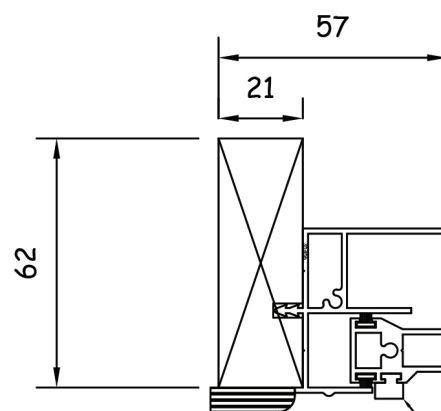

Optional Extras

White gasket
Chubb lock
White aluminium coupling / stacking interlock
Trickle vents / acoustic trickle vents
RAL colour
Flyscreen
Timber sizes other than standard

Specification:

Aluminium 6063T6 alloy to BS EN 755 standard, powder coated to BS 6496 to 60 micron finish.

Stock finishes: White - Interpon SA 098E high gloss, brown - van dyke and silver anodised. The sub-frame is manufactured from primed high quality, environmentally certified (MTCS) engineered timber. Standard sizes 45mm x 21mm & 62mm x 21mm.

All frames are factory glazed.
Standard gasket colour is black.

All frames include pvc-u trim as standard - Primed MDF or PEFC timber available upon request.

In line with our company policy of continuous product development and improvement, Granada reserves the right to make minor alterations to specification without notice.

Lift Out Reveal Fix Shuffle Glaze

Drg. No. LO RF Shuffle

Rev:

Scale: 1:20 & 1:2 (at A4)

GRANADA
secondary glazing

Campbell Way
Dinnington
Sheffield
S25 3QD

Tel: 01909 499 899
W: www.granadaglazing.com

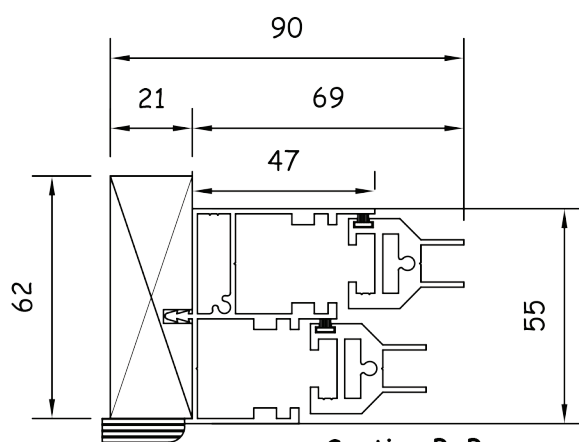
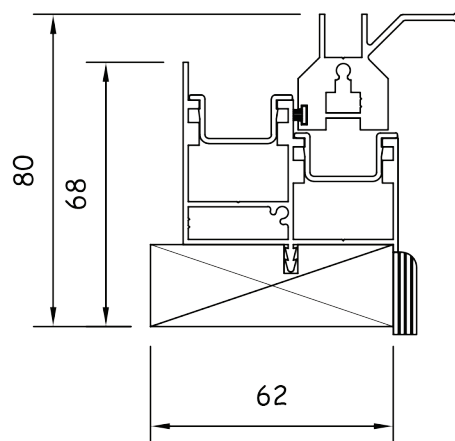
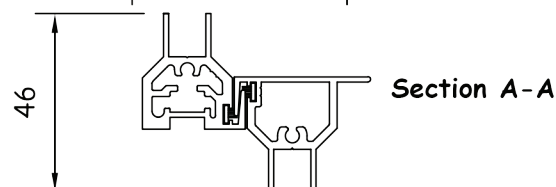
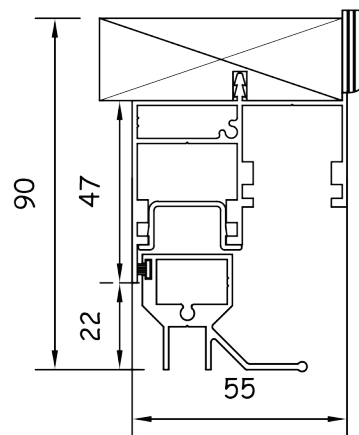
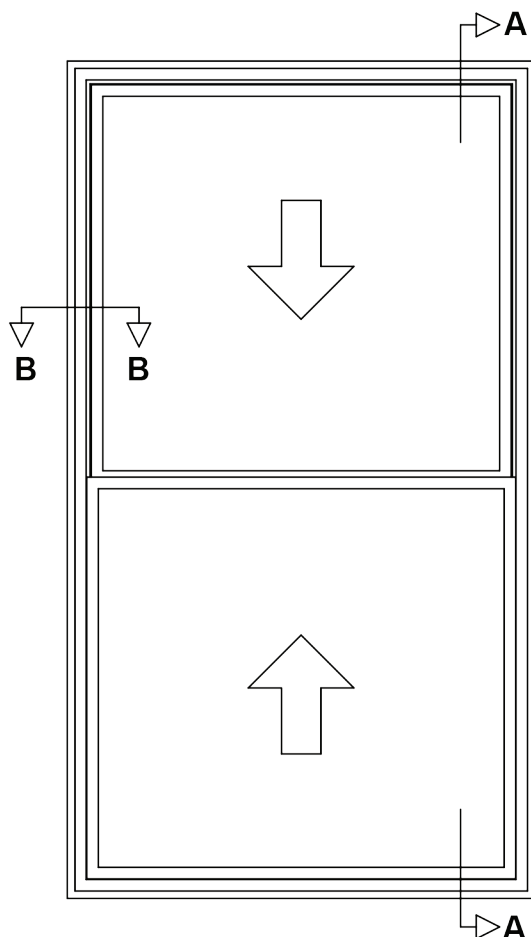

Section B-B

Specification:

Aluminium 6063T6 alloy to BS EN 755 standard, powder coated to BS 6496 to 60 micron finish.

Stock finishes: White - Interpon SA 098E high gloss, brown - van dyke and silver anodised. The sub-frame is manufactured from primed high quality, environmentally certified (MTCS) engineered timber. Standard sizes 45mm x 21mm & 62mm x 21mm.

All frames are factory glazed.

Standard gasket colour is black.

All frames include pvc-u trim as standard - Primed MDF or PEFC timber available upon request.

In line with our company policy of continuous product development and improvement, Granada reserves the right to make minor alterations to specification without notice.

Optional Extras

White gasket
Chubb lock
White aluminium coupling / stacking interlock
Trickle vents / acoustic trickle vents
RAL colour
Flyscreen
Timber sizes other than standard

Type: Lift Out Reveal Fix (50 x 21 Timber)

Drg. No. GS/05-001

Rev:

Scale: 1:20 & 1:2 (at A4)

 **GRANADA**
secondary glazing

Campbell Way
Dinnington
Sheffield
S25 3QD

Tel: 01909 499 899
W: www.granadaglazing.com

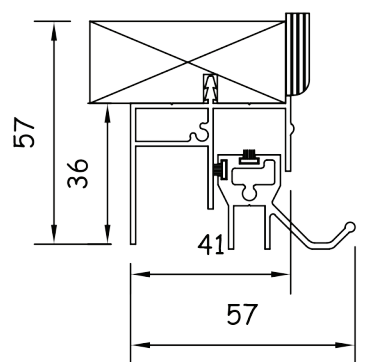
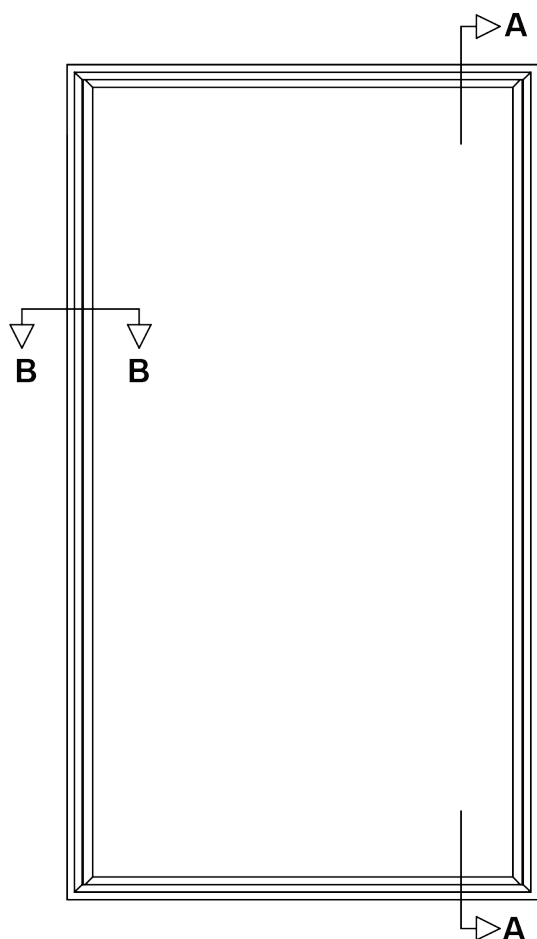

Section A-A

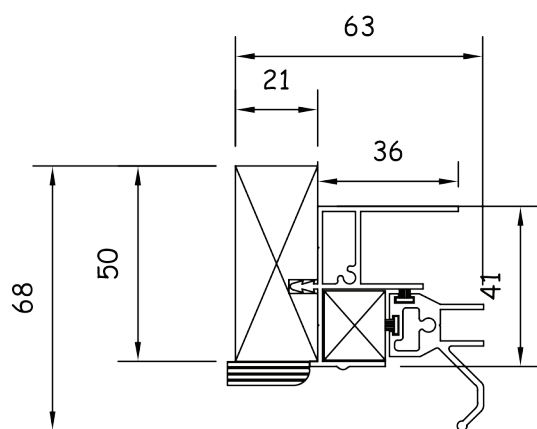
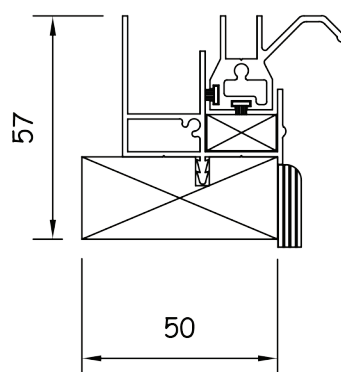

Section B-B

Specification:

Aluminium 6063T6 alloy to BS EN 755 standard, powder coated to BS 6496 to 60 micron finish.

Stock finishes: White - Interpon SA 098E high gloss, brown - van dyke and silver anodised. The sub-frame is manufactured from primed high quality, environmentally certified (MTCS) engineered timber. Standard sizes 45mm x 21mm & 62mm x 21mm.

All frames are factory glazed.

Standard gasket colour is black.

All frames include pvc-u trim as standard - Painted MDF or PEFC timber available upon request.

In line with our company policy of continuous product development and improvement, Granada reserves the right to make minor alterations to specification without notice.

Maximum size -

4mm glazing 1200mm diameter

6mm glazing 2000mm diameter

Optional Extras

White gasket

RAL colour

Flyscreen

Timber sizes other than standard



GRANADA
secondary glazing

Campbell Way
Dinnington
Sheffield
S25 3QD

Tel: 01909 499 899
W: www.granadaglazing.com

Type: Lift Out Circular Face Fix

Drg. No. LO Circular FF

Rev:

Scale: 1:20 & 1:2 (at A4)

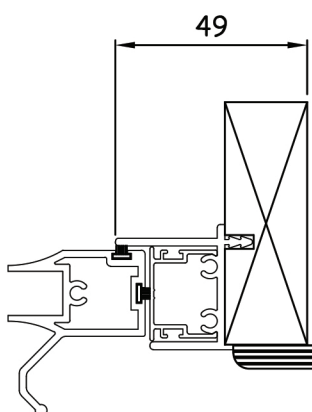
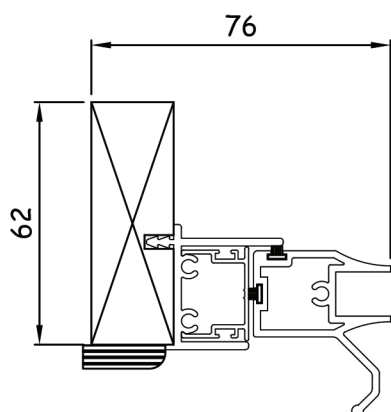
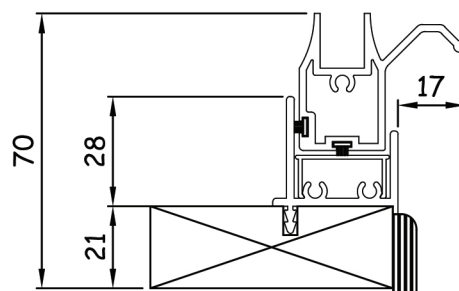
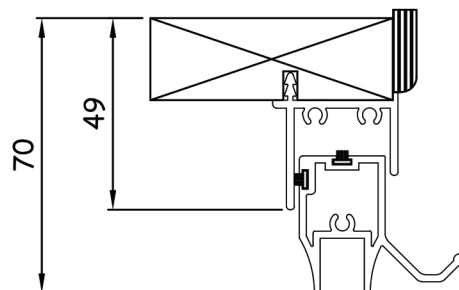
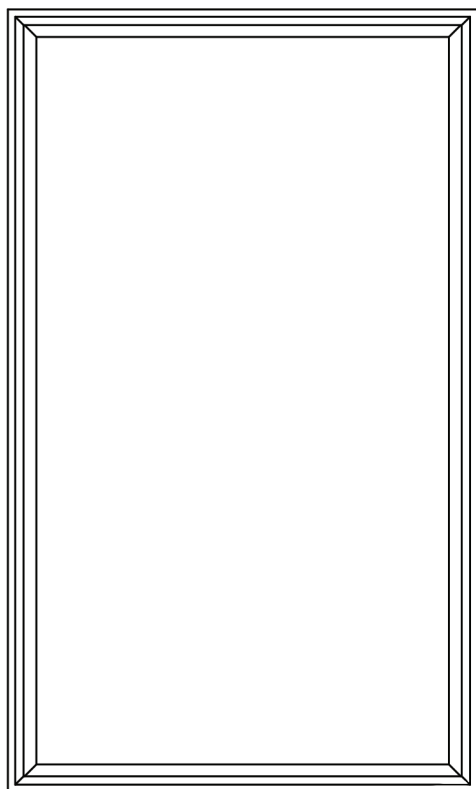

Standard Product Specification:

Aluminium 6063T6 alloy to BS EN 755 standard, powder coated to BS 6496 to 60 micron finish.

Stock finish: White - Interpon SA 098E high gloss. The sub-frame is manufactured from primed high quality, environmentally certified (MTCS) engineered timber. Standard sizes: Reveal Fix: 62mm x 21mm & Face Fix: 45mm x 21mm*.

All frames are factory glazed.

Standard gasket colour is black.

All frames include pvc-u trim as standard - Painted MDF or PEFC timber available upon request.

In line with our company policy of continuous product development and improvement, Granada reserves the right to make minor alterations to specification without notice.

* When coupling or stacking other heritage units timber size required: Reveal Fix: 70mm x 21mm & Face Fix: 62mm x 21mm.

Optional Extras

- White gasket
- Chubb lock
- Where stacking over 800mm, bespoke design required
- Aluminium coupling mullion
- Stacking interlock transom
- Trickle vents / acoustic trickle vents
- RAL colours
- Flyscreen
- Timber sizes other than standard available on request



Campbell Way
Dinnington
Sheffield
S25 3QD

Tel: 01909 499 899
W: www.granadaglazing.com

Type: Heritage Lift Out - Reveal Fix

Reference: HLO

Rev: 1